

PUSH & GEARED TROLLEY ^{CE}

1/2 to 30 Metric Ton Capacity

FEATURES

The easiest trolley installation ever.

- 1/2 to 5t installation and adjustment by rotating the threaded hanger shaft. 10 to 30t is from one side, trolley hanger shafts are fix mounted to the opposite side plate.
- Trolleys up to 5t have a 5:1 design factor and can be used for manual or powered hoist. Trolleys 10t and greater have a 4:1 design factor and must be de-rated for powered hoist
- Machined cast iron wheels with universal tread design to fit flat or tapered beam flanges.
- Low headroom design with precision sealed **"lubed for life"** bearings assure smooth operation.
- Durable all steel construction with standard safety lugs
- Geared trolley hand chain drop is standard with 10 feet
- Meets: ASME/ANSI B30.16, OSHA, NASA-STD-8719.9, EU Directives: 98/37/EC
- ATEX rated Ex II 3 GD c IIB 54° C X for limited use in Hazardous Environments



1/2 to 5t
PT Push Trolley



1/2 to 5t
GT Geared Trolley

OPTIONS

- Extended hand chain drop (standard with 10 ft.)
- Wide Flange Kits (must be ordered separately)

WIDE FLANGE KIT SPECIFICATIONS and DIMENSIONS (inches & lbs)

WLL	For Model	Trolley w/Kit weight (lbs)	B w/Kit	C w/Kit	Shaft Kit weight (lbs)	Wide Shaft Kit (Order Separately)
1/2t	PT005	19.1	14.8		5.1 lbs	PT005-FLG-12
1t	PT010	25.1	15.2		6.0 lbs	PT010-FLG-12
	GT010	36.1	15.2		6.0 lbs	
2t	PT020	41.8	15.6		9.0 lbs	PT020-FLG-12
	GT020	52.8	15.6	6.3-12.01	9.0 lbs	
3t	PT030	71.5	16.1		12.8 lbs	PT030-FLG-12
	GT030	85.4	16.1		12.8 lbs	
5t	PT050	96.8	16.3		17.9 lbs	PT050-FLG-12
	GT050	110.7	16.3		17.9 lbs	



Before using these products read and follow instructions in the operators manual. Never exceed capacity. Do not use for lifting people or loads over people.



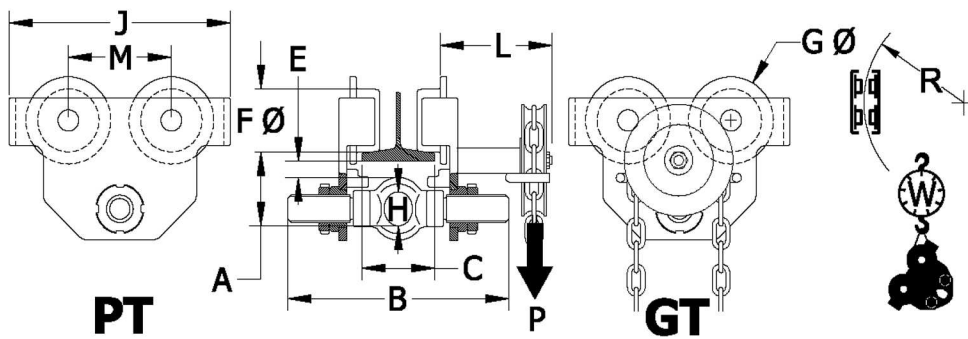

*W1 = weight as Standard.
*W2 = weight with Wide Flange Kit

1/2 to 5 metric Tonne PT & GT SERIES SPECIFICATIONS and DIMENSIONS
5 :1 Design for use with Manual or Powered Hoist (Inches and Pounds)

Model	WLL (5:1)	Standard			Wide Flg Kit		D	E	F	G	H	I	J	K	L	M (lbs)	P (lbs)	R Min	W1* (lbs)	W2* (lbs)
		A	B1	B2	C1	C2														
PT005	1/2t	3.3	11.5	14.8	2.52-8.66	6.30-12.01	0-0.12	1.5	2.3	3.4	1.2	0.9	8.9	6.8	---	4.0	---	36	18	19
PT010	1t	3.7	11.8	15.2	2.52-8.66	6.30-12.01	0-0.12	1.7	2.4	3.7	1.4	0.9	9.9	7.4	---	4.8	---	40	24	25
GT010															4.5	18	35	36		
PT020	2t	4.4	12.2	15.6	3.46-8.66	6.30-12.01	0-0.12	1.6	3.2	4.6	1.9	1.0	11.8	8.9	---	5.5	---	48	40	42
GT020															4.5	34	52	53		
PT030	3t	5.8	12.8	16.1	4.02-8.66	6.30-12.01	0-0.12	2.5	3.9	5.5	2.3	1.3	14.2	11.4	---	6.3	---	52	69	72
GT030															5.3	27	83	85		
PT050	5t	6.3	13.0	16.3	4.49-8.66	6.30-12.01	0-0.12	2.2	4.3	5.9	2.8	1.5	15.4	12.3	---	6.7	---	56	94	97
GT050															5.4	36	108	111		

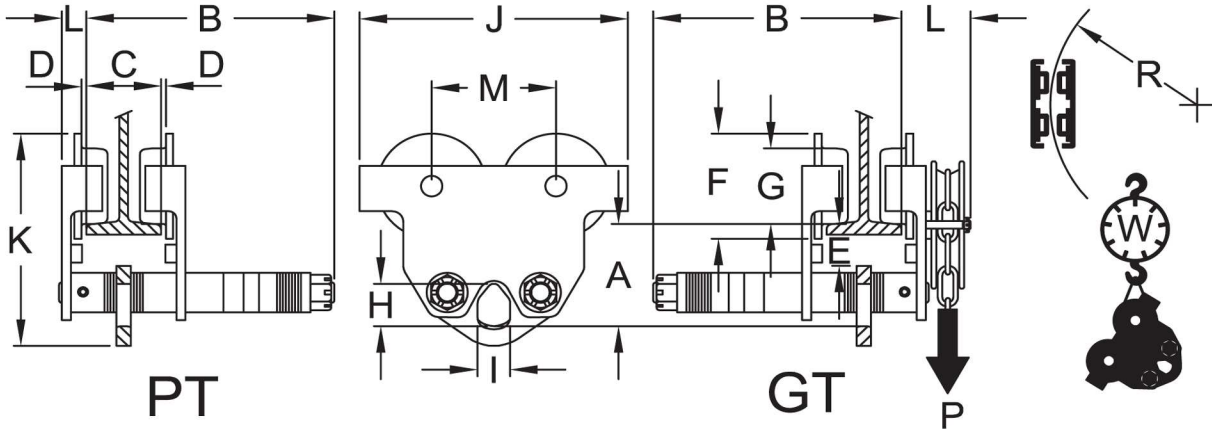

10 - 30 metric Tonne PT & Gt SERIES SPECIFICATIONS and DIMENSIONS
4:1 Design for Use With Manual Hoist. For Powered Hoist Reduce WLL by 20% (Inches and Pounds)

Model	WLL (4:1)	A	B	C	D	E	F	G	H	I	J	K	L	M	P (Lbs)	R Min	W (Lbs)
GT100	4.3	54	207														
PT160	16t	9.3	17.1	5.4-12	0.8-0.13	2.4	8.9	6.6	5.4	3.7	22.6	19.6	3.0	10.7	---	138	427
GT160													6.0	54	447		
GT200	20t	9.2	17.1	5.4-12	0.8-0.13	2.3	8.9	6.9	5.4	3.7	22.6	19.6	6.0	10.7	56	138	458
GT300	30t	11.2	17.8	6.9-12	0.8-0.13	2.7	11.2	9.1	6.1	4.1	28.7	24.4	6.2	13.5	56	236	733